

Sistema NB

PROFILO B10 e B12
Distanziale per lastre incollate o avvitate

NB System

B10 and B12 PROFILE
Spacer for slabs to be glued or screwed

Per il montaggio rapido ad aggancio e scivolo sui profili del sistema NB con l'utilizzo viti di sostegno regolabili

For fast sliding-anchorage assembly with adjustable screws on NB system

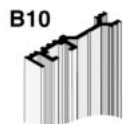
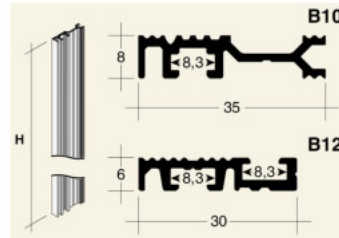

B10

Codici Codes	Al	H
B10.3012.		3020

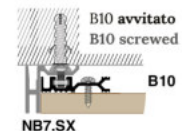
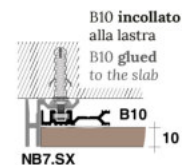

B12

Codici Codes	Al	H
B12.3012.		3020

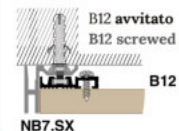
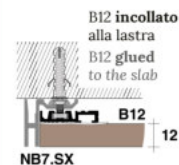

Fasi di montaggio Assembly steps

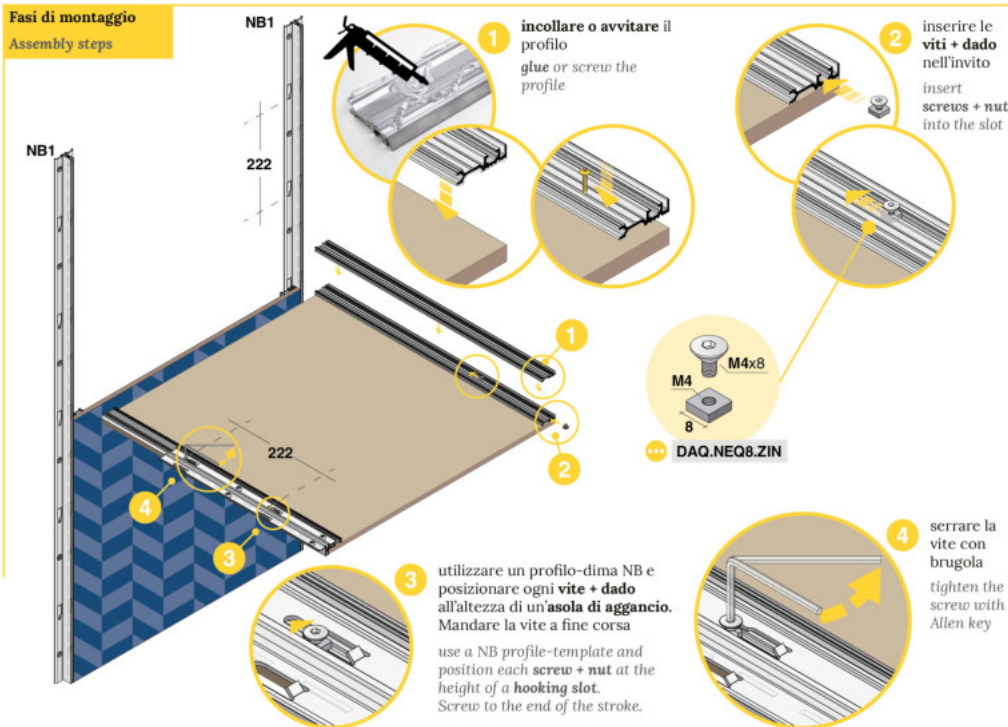

Finiture Finishings	Alluminio Aluminium	Al
Argento satinato Satinized Silver	NAT	consigliata per incollaggio recommended for gluing
Grezzo Raw	AGR	

codice code
XXX.XXXX.XXX* Asterisco = la finitura potrebbe non essere in pronta consegna.
Asterisk = finishing not always ready in stock.

Finiture disponibili per profili H = 3012 mm
Finishing available for profiles H = 3012 mm

Quote espresse in millimetri.
Dimensions are in millimeters.

Accessori correlati
Related accessories